

ROOMOR WALL 1.0 / 2.0

05-Sep.-2018

ROOMOR WALL 1.0 PAR16

max. 35W | GU10 | 100-240VAC | 50-60Hz
 CE IP20 45°/45°

BODY COLOUR

 red texture	338120R_
 grey texture	338120G_
 black texture	338120B_

OPTIONAL

No shade	00
SHADE 1.0	
 black texture	B1
 red texture + white	R1
 grey texture + white	G1
 black texture + gold	K1
 felt grey (max.15W)	F1

for PAR16 lamps see our catalogue

ROOMOR WALL 2.0 PAR16

max. 35W | GU10 | 100-240VAC | 50-60Hz
 CE IP20 45°/45°

BODY COLOUR

 black texture	338220B_
--	----------

OPTIONAL

No shade	00
SHADE 1.0	
 black texture	B1
 black texture + gold	K1
 felt grey (max.15W)	F1
SHADE 2.0	
 black texture	B2
 black texture + gold	K2
 felt grey (max.15W)	F2

for PAR16 lamps see our catalogue

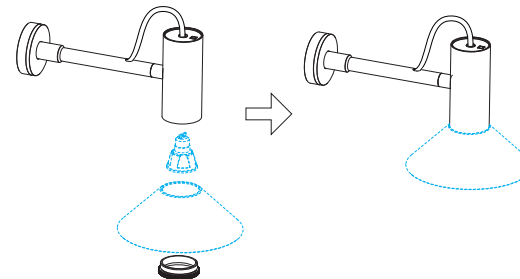
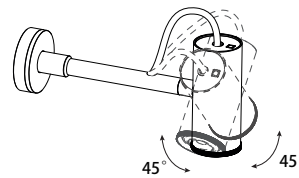
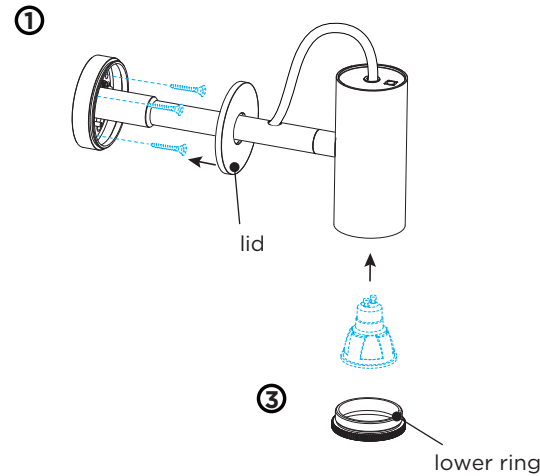
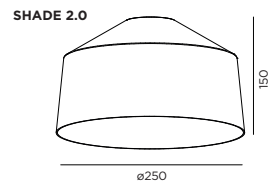
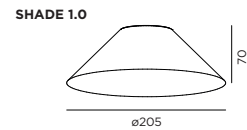

DIMENSIONS

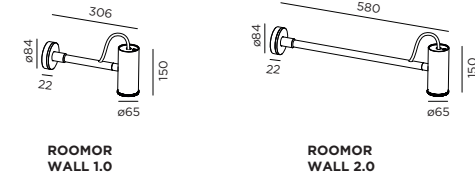

MOUNTING INSTRUCTION

① Open the lid, and mount the base on the wall.
(Ensure solid fixation on the wall.)
 and then close the lid by pressing.

② POWER CONNECTION

Connect the wires
 connection: STANDARD version

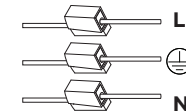

③ Unscrew the lower ring of the luminaire body,
 install a bulb (bulb is not included), and then
 screw the lower ring back.

