

# DOCUS

21-09-2015

## 2.0 LED

**LED** 2x8W | 220-240VAC | 50-60Hz | COB 2-step | incl. PS | phase-cut dim

CE IP20 960°C 0,3m 36° P

white texture	146464W
aluminium brushed	146464L
gold	146464G
copper	146464P
black texture	146464B

### LIGHT COLOUR

2200K | >80CRI | 2x315lm

2700K | >80CRI | 2x480lm

3000K | >80CRI | 2x480lm

1  
2  
4

## 2.0 PAR16

2xPAR16 max. 35W | GU10 | 220-240VAC | 50-60Hz

CE IP20 960°C 0,9m

white texture	146420W0
aluminium brushed	146420L0
gold	146420G0
copper	146420P0
black texture	146420B0

### OPTIONAL

for PAR16 lamps see our catalogue

### OPTIONAL

inner cover max. 10W

white texture	911021W1
gold	911021G1
black texture	911021B1

base plate dimensions (DOCUS 2.0 uses 2 x base plate)

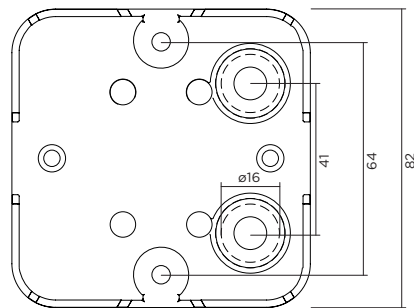

### 2.0 LED

### 2.0 PAR16

①



③

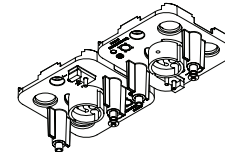
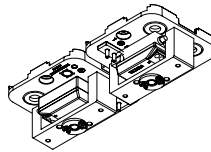

④

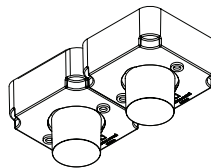

⑤

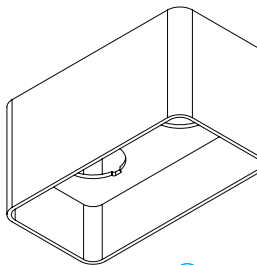
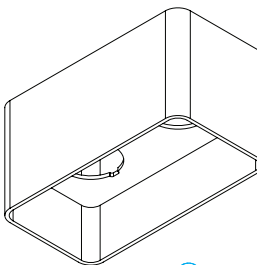

⑥

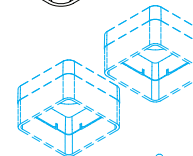
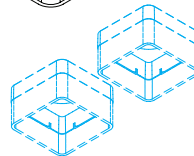

## DIMENSIONS

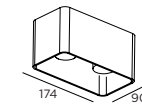

2.0 LED

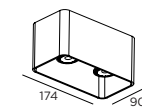

2.0 PAR16

## INSIDE PAR16

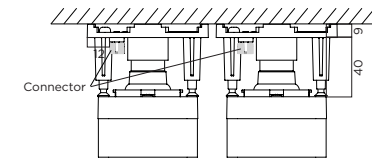

## MOUNTING INSTRUCTION

- ① Attach both bases to each other by using the plate (plate can be found inside the cover box)

## POWER CONNECTION

- ② SERIAL CONNECTION - for LED  
Always use **POWER SUPPLY**  
**350mA / 500mA**

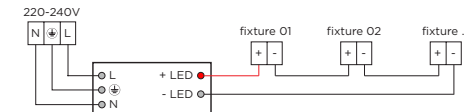

## PARALLEL CONNECTION - for PAR16

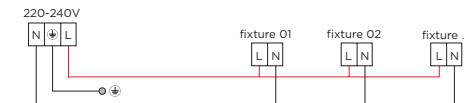

- ③ Mount the bases on the ceiling
- ④ **FOR 2.0 LED**  
Attach the LED housing on the base
- ⑤ **FOR 2.0 LED**  
Attach the box cover to the LED housing  
**FOR 2.0 PAR16**  
Attach the box cover to the base
- ⑥ **OPTIONAL inner cover**  
put the inner cover in the outer cover and turn partially.  
In case of PAR16 with inner cover: max. 10W



WEVER & DUCRÉ  
LIGHTING

www.weverducre.com

INSTALLATION  
INSTRUCTIONS