

Tube

VIBIA

6115

Design By Ichiro Iwasaki

Ceiling lamp with three shades of different sizes. Featuring a curved sheet aluminium shade lending a visual and material lightweight quality.

Model Sheet

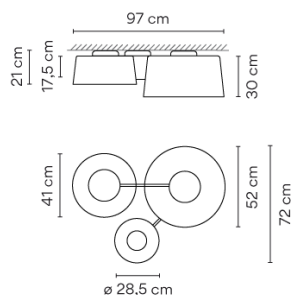

Finish	 71 Grey L2, Grey M1, Black Grey NCS S 2500-N, S 4500-N, S 7000-N
	 24 Beige M1 NCS S 2005-Y50R
	 37 Terra Red NCS S 4040-Y70R
	 10 White NCS S 0300-N

LED temperature color 2700 K / 3000 K / 3500 K / 4000 K

Dimming DALI 1-10V Push

Installation type Surface Canopy

Materials LED support: Aluminum
Ceiling rose: Steel

Light source 1 x LED PLATE 20W 700mA
1 x LED PLATE 25W 700mA
1 x LED PLATE 13,5W 700mA



LED CRI>90 8120 lm 138
2700 K / 3000 K / 3500 K / 4000 K

Driver Constant Current 700 110~240
V V 50~60 Hz HZ

Remarks Main input by the biggest shade

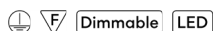

Application Ceiling Lamps

Packaging 2 Box
0.366 m x 0.709 m x 0.709 m
Gross weight 15.3
Net weight 4.7
Vol. 0.2148

Lighting effect

General Lighting

Lamp for general lighting that equally distributes the light in all directions.

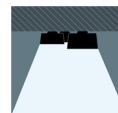

Photometric Data

Efficiency	47.41 lm/W
Coordinate System	CG
Total Flux	3249.68 lm
Maximum Value	1269.56 cd

All of our products come with a five-year warranty. Check our legal terms at www.vibia.com/warranty

Vibia Lighting, S.L.U.

Office / Oficina
Progrés 4-6. 08850 Gavà. Barcelona, Spain.

International T +34 934 796 971
Spain / Portugal T +34 934 796 970

customer.service@vibia.com
vibia.com