

# FLOS

03.6150.GN Green

## Wan Downlight

Designed by Johanna Grawunder, 2013



LED retrofit - Beam° 68

Recessed luminaire with main voltage source.

Are you a professional and your project needs consulting and support?

[BOOK AN APPOINTMENT](#)

### Main specifications

|                 |                     |
|-----------------|---------------------|
| Mounting        | Ceiling recessed    |
| Environments    | Indoor dry location |
| Lamp category   | LED retrofit        |
| Lamp type       | QT-14               |
| Lamp holders    | G9                  |
| Ilcos           | No                  |
| Number of heads | 1                   |

### Physical

|                     |       |
|---------------------|-------|
| Colour              | Green |
| Trim                | No    |
| Orientation         | Fixed |
| Recessed depth (mm) | 111   |
| Net weight (kg)     | 0.35  |
| IP internal         | 44    |
| IP external         | 44    |

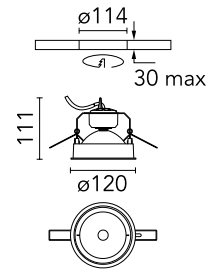

### Download

Mounting instructions [↓ PDF](#)

### Photometric Files

LDT / IES [↓ ZIP](#)

### Technical Drawings

2D [↓ ZIP](#)

3D [↓ ZIP](#)



### Photometric

|                        |           |
|------------------------|-----------|
| Lighting type          | Direct    |
| Light distribution     | Symmetric |
| Beam angle C0-180 (°)  | 68        |
| Beam angle C90-270 (°) | 68        |

### Electrical

|                  |       |
|------------------|-------|
| Insulation class | II    |
| Frequency (Hz)   | 50/60 |
| Dimmable         | No    |
| Emergency type   | No    |

