

# Flat

VIBIA

5905

Design By Ichiro Iwasaki

Flat is a ceiling lamp composed of horizontal discs at various heights that create planes of reflected light. The Flat ceiling light has a strong graphic quality, combining structure and functionality.

## Model Sheet

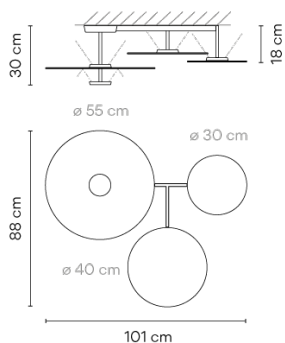

**Finish**

- 71 White, Green L1, Off-White  
NCS S 0300-N, NCS S 4005-G80Y, NCS S 1000-N
- 10 White  
test ral

**LED temperature color** 2700 K / 3500 K / 4000 K

**Dimming** DALI 1-10V Push

**Installation type** Surface Canopy

**Materials**

- Ceiling rose: Steel
- Reflector: Aluminum
- Body: Steel
- Head: Aluminium

**Light source** 4 x LED PLATE 13,5W 700mA



**LED** CRI>90 6960 lm 128.88  
2700 K / 3500 K / 4000 K

**Driver** Constant Current 700  
220-240 V V 50-60 Hz HZ

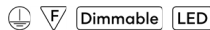

**Application** Ceiling Lamps

**Packaging** 1 Box  
0.727 m x 0.727 m x 0.32 m  
Gross weight 25.8  
Net weight 15.38  
Vol. 0.1691

**Lighting effect**

**General Lighting**

Lamp that emits an upward or backward beam that is reflected by the ceiling or wall.

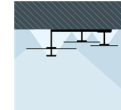

**Photometric Data**

**Efficiency** 68.21 lm/W  
**Coordinate System** CG  
**Total Flux** 3015.66 lm  
**Maximum Value** 826.00 cd

**Other Applications**

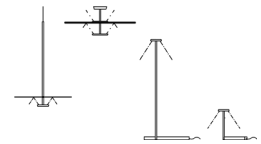

All of our products come with a five-year warranty. Check our legal terms at [www.vibia.com/warranty](http://www.vibia.com/warranty)

**Vibia Lighting, S.L.U.**

**Office / Oficina**  
Progrés 4-6. 08850 Gavà. Barcelona, Spain.

**International** T +34 934 796 971  
**Spain / Portugal** T +34 934 796 970

[customer.service@vibia.com](mailto:customer.service@vibia.com)  
[vibia.com](http://vibia.com)