

ROOMOR TABLE 1.0

10-Sep.-2018

ROOMOR TABLE 1.0 PAR16

max. 35W | GU10 | 100-240VAC | 50-60Hz
 CE IP20 45°/45° 30°/30°

BODY COLOUR

 red texture	637120R_
 grey texture	637120G_
 black texture	637120B_

OPTIONAL

No shade	00
----------	----

SHADE 1.0

 black texture	B1
 red texture + white	R1
 grey texture + white	G1
 black texture + gold	K1
 felt grey (max.15W)	F1

for PAR16 lamps see our catalogue

SHADE 1.0

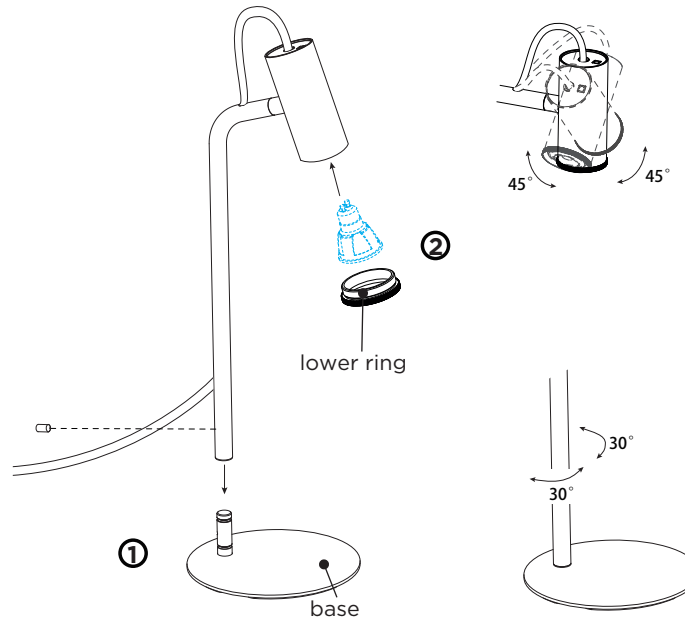
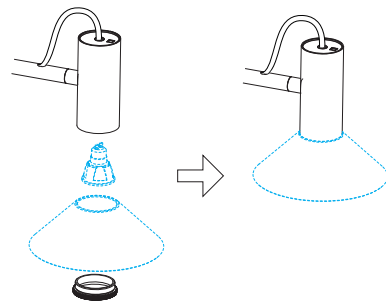
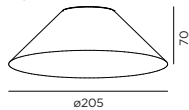

DIMENSIONS

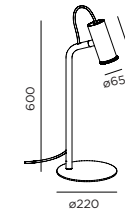

ROOMOR TABLE 1.0

MOUNTING INSTRUCTION

- ① Install the lamppost on the base; and lock them with the allen screw.
- ② Unscrew the lower ring of the luminaire body, install a bulb (bulb is not included), and then screw the lower ring back.
- ③ Power connected with the plug.

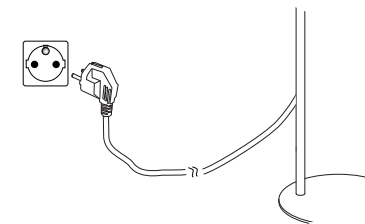

PB19-010-597-00



WEVER & DUCRÉ
LIGHTING

www.weverducre.com

Wever & Ducre bvba Spinnerijstraat 99/21 8500 Kortrijk

INSTALLATION INSTRUCTIONS